



BC9101 Series LED Explosion proof Light

LED



ATEX Ex Marking:

2 GD
Ex d B T6 Gb ,
Ex tb C T80 Db

Standard: GB3836.1, GB3836.2

EN60079-0: 2009, EN60079-1: 2007,

EN60079-31: 2009

IEC60079-0: 2007, IEC60079-1: 2007,

IEC60079-31: 2008

Light distribution curve

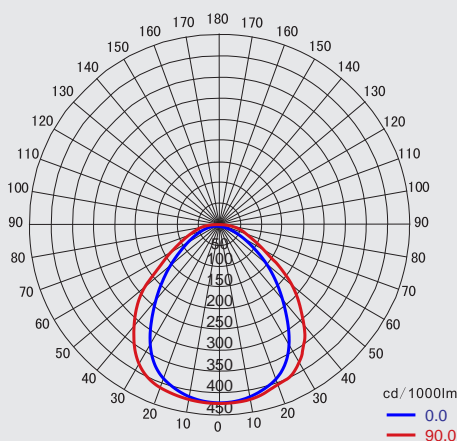

Application

- Ideal to be used in the oilfield, chemical industry, steel industry, power, port, Petroleum etc.
- Harsh environment, moist area.
- Gas explosive environment: Group IIA; IIB.
- Zone 1, Zone2; Zone 21, Zone 22.
- Temperature class: T1 to T6.

Characteristics

- With its reflector which have different angles design, it efficiently utilize the light. Have a good performance of illuminance uniformity, glare free, can avoid eyestrain to the worker.
- It adopts American CREE LED as light source, can save 60% or more on energy than metal halide lamp.
- The housing is especially designed to dissipate heat, which increase the efficiency and lifespan of the LED, so that to ensure the 100,000 hours LED lifespan.
- World top ranking Taiwan Meanwell LED Driver, power factor:0.98, has a highly stable performance.
- The adjustable locking device on the bracket can tightly fix the lamp to any desired angle, making the lamp resist to harsh vibration
- The anti corrosion, abrasion proof, power coated cover which is dust proof, water proof , make the lamp an excellent option for all kinds of high stress environment.
- Multiple mounting options including ceiling mounting, pendent mounting, wall mounting etc.
- The lamp can parallel connected , no need to use the junction box.
- 18~43VAC or 18~55VDC is optional for 25W and 40W as customer's requirement.

Technical Specification

Input Voltage	90~305VAC / 127~431VDC
Frequency	50Hz / 60Hz
Anti corrosion grade	WF2
Insulation Grade	I
Spacing height ratio	4.5
Screw Thread	G3/4
Cable Diameter	8mm~ 14mm
Dimension	370 × 326 × 88mm
Net Weight	6.5Kg

BC9101 Series LED Explosion proof Light



Ordering reference

Model Number	Input Voltage	Light source	Rated wattage (W)	Light output (lm)	Equivalent to			
					Metal Halide Lamp	Electrode Less Lamp	Energy Saving Lamp	High Pressure Mercury Lamp
BC9101-L25	90~305VAC or 127~431VDC	LED	25	3,300	70W	60W	80W	80W
BC9101-L40		LED	40	5,508	100W	100W	130W	125W
BC9101-L60		LED	60	8,138	150W	135W	180W	175W
BC9101-L80		LED	80	9,168	175W	165W	/	250W
Optional								
BC9101-L25-D	18~43VAC or 18~55VDC	LED	25	3,300	70W	60W	80W	80W
BC9101-L40-D		LED	40	5,508	100W	100W	130W	125W

Drawing of dimension (Dimensions in mm)

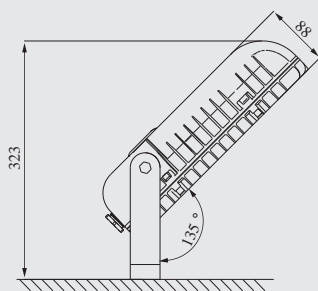

Seat-mounting

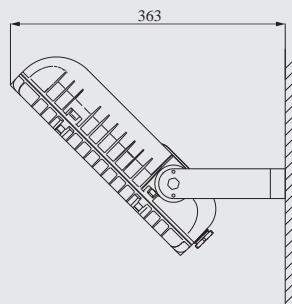

Side wall-mounting

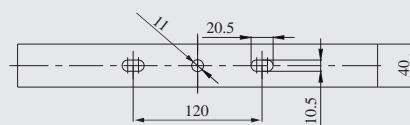
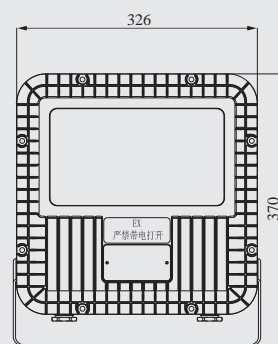

Mounting size